



Index:

Information	86
Series ORK	86
Series ORM	86
Series ORL	87
Series OR	87
Series LOR	88
Series MR	88
Series CR	89
Series CRS	89
Cable Reels	89
Workshop Tower, Stand, Brackets ...	90-91

Hose Reels , Open

Part.No

Wherever longer hoses are required it is strongly recommended that hose reels be used. There are several advantages from using hose reels, such as longer hose life, increased safety and improved efficiency. Once installed the hose is always readily available but can be retracted out of the way when not in use. Hose free floors will reduce the risk of accidents due to tripping and will also aid identification. As a consequence they help to increase the efficiency and hence the profitability of the workshop. Hose reels can be installed on the wall or ceiling or to special frameworks. We recommend that they should be installed at least 2,5 meters above the floor.

Series ORK

Open hose reels for air, water, oil, grease and waste oil suction. Manufactured in sheet metal, painted in blue. The air and water reels have a simple cord braided hose and the oil and grease reels have a steel braided hydraulic hose. All hoses are fitted with swaged couplings. The Vacuum hose reel is specially designed for this purpose and the hose is fitted with a waste oil nozzle for quick connection of probes.

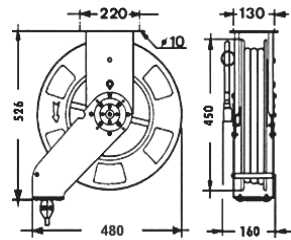

Media	Hose lengths metre	Hose dimension mm-inch	Max work pressure MPa-bar		Inlet thread BSP	Outlet thread BSP
Air/Water	10	10-3/8"	1,5-15	44231	Hose 12,5-1/2"	Hose 10-3/8"
Oil/ Air	10	12,5-1/2"	7,5-75	24911	G1/2 (m & f 60°)	G1/2 (m & f 60°)
Grease	10	6,35-1/4"	40-400	14206	G1/4" (f)	G1/4" (m)
Waste oil suction	6	19-3/4"	vacuum	24472	G3/4" (f)	Waste oil nozzle
Various	max 10	without hose	7,5-75	24903	G1/2" (f)	G3/8" (f)
Pivoting wall bracket				28903		



28903



Series ORM

Open hose reel for air, water, oil and grease. Manufactured in sheet metal, painted in blue. The air reels have a simple cord braided hose and oil and grease reels have a steel braided hydraulic hose.

All hoses are fitted with swaged couplings.

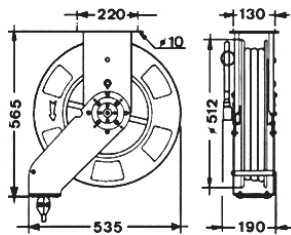

Media	Hose lengths metre	Hose dimension mm-inch	Max work pressure MPa-bar		Inlet thread BSP	Outlet thread BSP
Air/Water	15	12,5-1/2"	1,5-15	44241	Hose 12,5-1/2"	Hose 12,5-1/2"
Oil/ Air	15	12,5-1/2"	7,5-75	24922	G1/2 (m & f 60°)	G1/2 (m & f 60°)
Grease	15	10-3/8"	40-400	14218	G3/8" (f)	G3/8" (m)
Hot water	15	10-3/8"	18-180	24935	G1/2" (f)	G3/8" (m)
Various	max 15	without hose	7,5-75	24904	G1/2" (f)	G3/8" (f)
Pivoting wall bracket				28903		



28903



Hose Reels, Open

Part.No

Series ORL

Heavy duty open hose reel with longer hose lengths for oil and air. All hoses are fitted with swaged couplings.

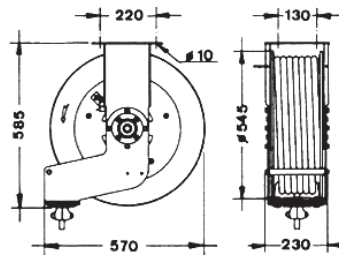

Media	Hose lengths metre	Hose dimension mm-inch	Max work pressure MPa-bar	Part.No	Inlet thread BSP	Outlet thread BSP
Oil/Air	20	12,5-1/2"	7,5-75	24931	G1/2 (m & f 60°)	G1/2 (m & f 60°)
Oil/Air	15	19-3/4"	7,5-75	24932	G3/4 (m & f 60°)	G3/4 (m & f 60°)

Series OR

Open hose reel with longer hose lengths for oil, grease, air and water. If mounted to the ceiling the hose guide must be located to give correct hose direction. All hoses are fitted with swaged couplings.

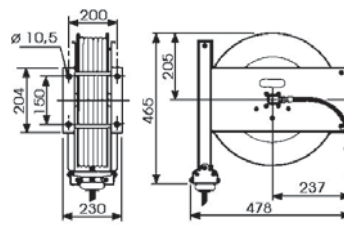

Media	Hose lengths metre	Hose dimension mm-inch	Max work pressure MPa-bar	Part.No	Inlet thread BSP	Outlet thread BSP
Air	20	12,5-1/2"	1,8-18	44240	G1/2" (m)	G1/2" (m)
Oil/ Air	20	12,5-1/2"	6-60	24920	G1/2" (m)	G1/2" (f)
Grease	15	10-3/8"	40-400	14216	G3/8" (m)	G3/8" (m)
Hot water/ Stainless steel	20	10-3/8"	18-180	24957	G3/8" (m)	G3/8" (m)
Various with stainless steel swivel Pivoting wall bracket	max 20	without hose	40-400	24955	Connection thread	G3/8" (f)
				28902		

Hose Reels, Open & Enclosed

Part.No

Series LOR

Open hose reel for oil, grease, air and water. Steel braided, oil resistant rubber hose.
Max temperature +50°

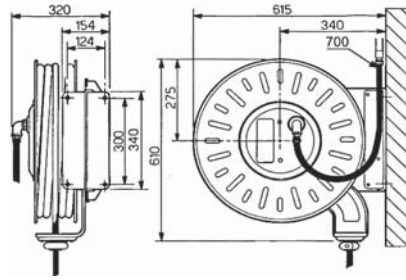

Media	Hose lengths	Hose dimension	Max work pressure	Part.No	Inlet thread BSP	Outlet thread BSP
	metre	mm-inch	MPa-bar			
Oil/ Air	25	12,5-1/2"	6-60	24941	G1/2" (f)	G1/2" (f)
Oil/ Air	20	19-3/4"	6-60	24943	G3/4" (f)	G3/4" (f)
Oil/ Air	15	15-1"	6-60	24945	G1" (f)	G1" (f)
Grease	25	10-3/8"	40-400	14225	G3/8" (f)	G3/8" (f)
Hot water, max 150°C	25	10-3/8"	40-400	24961	G3/8" (f)	G3/8" (f)
Hot water, max 150°C	25	12,5-1/2"	30-300	24963	G3/8" (f)	G3/8" (f)
Hot water/Stainless max 150°C	25	12,5-1/2"	30-300	24965	G1/2" (f)	G1/2" (f)
Stainless steel	25	Without swivel and hose		24960		

Inlet thread BSP	Outlet thread BSP
G1/2" (f)	G1/2" (f)
G3/4" (f)	G3/4" (f)
G1" (f)	G1" (f)
G3/8" (f)	G3/8" (f)
G3/8" (f)	G3/8" (f)
G3/8" (f)	G3/8" (f)
G1/2" (f)	G1/2" (f)

Series MR

A medium sized enclosed hose reel for different types of media. For example air, water, oil or grease.
The hose reel can be mounted on the ceiling, the wall or the floor. The Vacuum hose reel is specially designed for waste oil suction, the hose is fitted with a waste oil nozzle for quick connection of probes.

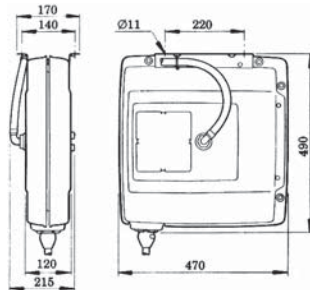

28903

Media	Hose lengths	Hose dimension	Max work pressure	Part.No	Inlet thread BSP	Outlet thread BSP
	metre	mm-inch	MPa-bar			
Air/Water	15	10-3/8"	1,5-15	844220	Hose 12,5-1/2"	Hose 10-3/8"
Air/Water	10	12,5-1/2"	1,5-15	844230	Hose 12,5-1/2"	Hose 12,5-1/2"
Oil/Air	15	10-3/8"	7,5-75	824905	G1/2" (f)	G3/8" (f)
Oil/Air	10	12,5-1/2"	7,5-75	824910	G1/2" (f)	G1/2" (f)
Grease	10	6,35-1/4"	35-350	814205	G1/4" (f)	G1/4" (f)
Grease	15	6,35-1/4"	35-350	814210	G1/4" (f)	G1/4" (f)
Grease	10	10-3/8"	35-350	814215	G3/8" (f)	G3/8" (f)
Hot water, max 150°C	13	10-3/8"	18-180	824951	G3/8" (f)	G3/8" (f)
Wind screen wash/	10	10-3/8"	7,5-75	824440	G1/2" (f)	G1/2" (f)
Degreaser	15	10-3/8"	7,5-75	824445	G1/2" (f)	G1/2" (f)
Waste oil suction	5	19-3/4"	Vacuum	24492	G3/4" (f)	Waste oil nozzle
Pivoting wall bracket				28903		

Inlet thread BSP	Outlet thread BSP
Hose 12,5-1/2"	Hose 10-3/8"
Hose 12,5-1/2"	Hose 12,5-1/2"
G1/2" (f)	G3/8" (f)
G1/2" (f)	G1/2" (f)
G1/4" (f)	G1/4" (f)
G1/4" (f)	G1/4" (f)
G3/8" (f)	G3/8" (f)
G3/8" (f)	G3/8" (f)
G1/2" (f)	G1/2" (f)
G1/2" (f)	G1/2" (f)
G3/4" (f)	Waste oil nozzle

Hose Reels, Enclosed and Electric Cable Reels

Part.No

Series CR

Enclosed hose reels for oil, grease, air, water and detergents. All hoses have swaged couplings.

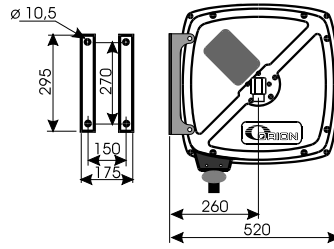

Media	Hose lengths	Hose dimension	Max work pressure	Part.No	Inlet thread	Outlet thread
	metre	mm-inch	MPa-bar			
Air	15	10-3/8"	1,8-18	44220	G3/8" (f)	G3/8" (m)
Air	10	12,5-1/2"	1,8-18	44230	G1/2" (f)	G1/2" (m)
Oil/Air	15	10-3/8"	6-60	24905	G3/8" (f)	G3/8" (f)
Oil/Air	10	12,5-1/2"	6-60	24910	G1/2" (m)	G1/2" (f)
Grease	10	6,35-1/4"	40-400	14205	G1/4" (f)	G1/4" (f)
Grease	15	6,35-1/4"	40-400	14210	G1/4" (f)	G1/4" (f)
Grease	10	10-3/8"	40-400	14215	G3/8" (f)	G3/8" (f)
Hot water, max 150°C	10	10-3/8"	18-180	24951	G3/8" (f)	G3/8" (f)
Degreaser	15	6,35-1/4"	6-60	24953	G3/8" (f)	G1/4" (f)
Various	max 15	without hose	40-400	24950	Connection thread	G3/8" (f)
Pivoting wall bracket				28900		

Series CRS

Enclosed hose reel for air and water, complete with pivoting wall bracket. Hoses have swaged couplings.

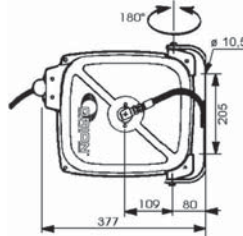

Media	Hose lengths	Hose dimension	Max work pressure	Part.No	Inlet thread	Outlet thread
	metre	mm-inch	MPa-bar			
Air/Water	12	8-5/16"	2-20	44205	G3/8" (m)	G1/4" (m)
Air/Water	10	10-3/8"	2-20	44210	G3/8" (m)	G3/8" (m)

Electric Cable Reels

Electric cable reels with impact resistant plastic covers. Supplied with earth connection and cable.

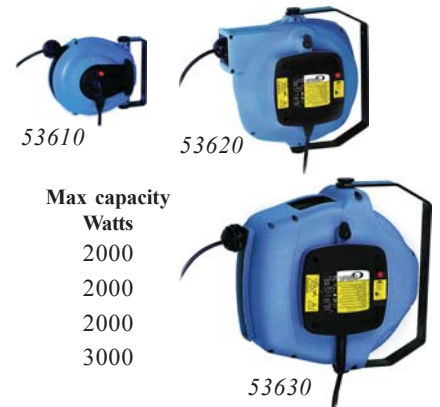

Media	Cable lengths	Cable	Power	Part.No	Max capacity
	metre				
Electric cable	6	HO5VV-F 3x1,5 mm ²	230	53610	2000
Electric cable	10	HO5VV-F 3x1,5 mm ²	230	53620	2000
Electric cable	15	HO5VV-F 3x1,5 mm ²	230	53630	2000
Electric cable	20	H07RN-F 5x1,5 mm ²	400	53640	3000

Hose Reel, Accessories

Part.No

Hose Outlet Roller guide

Additional hose outlet roller guide, used when mounting a hose reel in a cabinet. LxW 150x150 mm. Max. hose dimension ø 25 mm.

2245931

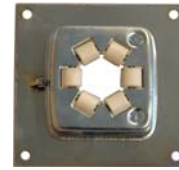

Mounting Rack

Mounting racks are used to facilitate the mounting of several hose reels. Time is reduced and the work can easily be done by one person. Pre-drilled holes for ORK, ORM, ORL and MR reels.

Description	LxWxH (mm)
For up to three reels	820x310x60
For up to five reels	1375x310x60

92143
92145



92143

Support Post for Hose Reels

To mount one or two reels (side by side). Easy to assemble. Pre-drilled holes.

Description	For reels
Support Post, one or two reels (side by side)	ORK, ORM, MR
Support Post, one single reel	MR
Support Post, two reels (side by side)	MR
Support Post, two reels (back to back)	MR

92130
SRP/1MR
DRP/2MR
TRP/2MR

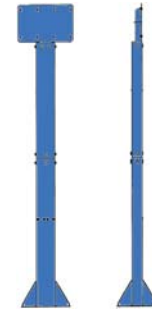

Service Stand

Standard service stand, for up to six hose reels, manufactured in blue laquered steel. The stand has two lockable drawers, waste basket, wipe off paper holder, writing desk, tool hangers and drip tray. Pre-drilled holes for ORK, ORM, ORL and MR reels. The stand is delivered complete as per picture.

Dimensions H xW x D 2500 x 700 x 1640 mm

92150



Hose Reel, Accessories

Part.No

Service Tower

The workshop tower can be equipped with a variety of product and provides a single source center for oil, grease, antifreeze, air and exhaust systems.

Description

Service tower

Grease holder, for 60 kgs grease drum

Concrete fastener (floor bracket), Zinc plated

Dimensions H x W x D 3500 x 800 x 800 mm

92115

92116

92117

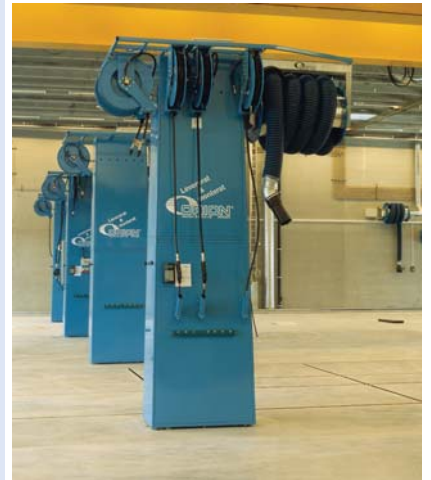

Service Stand

An alternative to the Service Tower, when space is limited. Supplied in sections according to your requirements. Supply pipework can be from the floor or from above. Also available with drip tray and work bench.

Suitable for use with all hose reels and exhaust extraction units.



Notes:

A series of horizontal dotted lines for taking notes, spanning the width of the page below the 'Notes:' label.